

2023
DEWITT COUNTY SHUTTERBUGS
PHOTOGRAPHY CONTEST AND EXHIBITION

Location: Cuero Municipal Library, 207 E. Main Street, Cuero, Texas, 77954
Hours: Monday-Friday 8:30-5:30, Saturday 9:00-12 noon

Schedule:

February 8-March 22: Submission window for entries: All entries must arrive at the Cuero Municipal Library, 207 East Main, Cuero, TX., 77954 between **Wednesday, February 8 and Wednesday, March 22.** No entries will be accepted after the deadline.

Note: the Library closes at 12:00 noon on Saturdays.

March 25: Entries are judged.

March 27-April 28: Photography Exhibition.

April 29: Entry Pick up 9:00 a.m. - 12 noon, Cuero Municipal Library, unless arrangements have been made for entries to be shipped back. **ENTRIES MUST BE PICKED UP NO LATER THAN MAY 13, 2023 OR THEY WILL BE DISPOSED OF.**

Awards:

1st Place in each category

2nd Place in each category

3rd Place in each category

Special Texas Wildflower Award

Best of Show

Adult Division

\$50 & ribbon

\$40 & ribbon

\$30 & ribbon

\$80 & ribbon

\$100 & ribbon

Youth Divisions

\$30 & ribbon

\$20 & ribbon

\$10 & ribbon

Adult Division:

Entry Fee is \$5 per entry-no limit per category.

All entries must meet submission requirements.

For an entry to be eligible for Texas Wildflower Award photographer must designate within the Flowers/Plants category that it is a Texas wildflower. Flower must be identified. (Landscapes are not eligible for this award).

Categories (adult division)

Animals

Architecture

Black and White

Flowers/Plants

Birds

Landscapes/Scenic

Miscellaneous

Portraits/People

Creative Effects

Action

Youth Divisions: Junior Division is for students 8th grade and below, Senior Division is for students 9th-12th grades.

Youth Entry Fee is \$3 per entry All Youth entries will compete in two general Youth Division categories divided by age.

On the 3.5"x2" card and on the envelope on the back of photo, state Junior or Senior Division and grade level.

Youth exhibit will be limited to only the highest scoring entries.

With the exception of the entry fee and category, all other contest rules are the same as those of the Adult Division. Youth may opt to enter the adult division if they choose to do so.

Judging:

Images will be judged on technical merit and artistic impression.

Entries will be judged by three qualified judges and receive a score of 1 to 10 from each judge. Scores will be totaled and used to rank the images.

Only the highest scoring photos in each category (approximately 250) entries will be exhibited.

The contest and display are completely at the discretion of the DeWitt County Shutterbugs.

Contact Persons:

Michele Bennett 361-275-4449 dcshutterbugs@yahoo.com or Dianna Bartosh-361-275-6336 diannabartosh@icloud.com

Category Definitions

Action: The main element shows someone or something in motion.

Animals: The animal is the main element in the image, this includes both warm and cold blooded animals.

Architecture: The design element of human engineering and art.

Birds: The bird is the main element in the image.

Black & White: All monotone images.

Portraits/People: Portraits and casual images of a person or persons.

Flowers/Plants: All flowers and plant life in which the plant forms the main element of the photograph. Landscapes are excluded from this category.

Landscapes/Scenic: Includes landscapes, cloudscapes, seascapes and cityscapes.

Miscellaneous: Images that do not fit the other categories.

Creative Effects: Photographs manipulated for artistic purposes by applying digital and or traditional special effects. This includes changing the reality of the image by cloning objects into or out of the image, adding filters, and photo composites. Photos that have basic adjustments including removing sensor spots, adjustments to color balance, contrast and exposure, dodging and burning, or sharpening, are eligible in all categories.

Texas Wildflower Award: A Texas Wildflower award is given to the highest scoring image highlighting Texas Wildflowers that is entered in the Flowers/Plants category.

Mounting/Matting Requirements

Photos may be any size up to 8"x12" and **must be matted to 11"x14"**. Mats are available for purchase at craft stores such as Hobby Lobby, Michaels, or on Amazon.com.

Entries must be unframed.

Photograph, mat and **stiff-backing** (such as foam core, mat board or heavy weight cardboard) must be securely adhered together to create a single photographic display (refer to diagram on page 4).

No photographer's signature or other marking on the front of the photograph or mat is allowed.

Entries in plastic sleeves do not show well during judging and should not be used.

Photos matted in white, gray or black mats show best, but other colors are allowed.

Submission Requirements:

- Complete and include the ***submission form*** found on page 4 itemizing photographer's entries by category and title. Include name, address, **e-mail address**, telephone number and the total of entry fees.
- The name, address and phone number of the exhibitor must be on the back of each entry. An envelope must be attached to the entry backing containing a **3.5"x2"** card with the photographer's name, city of residence, category entered, and title of the photo. The card will be used for display in the April Exhibition. Category entered must also be printed on the outside of the envelope containing the **3.5"x2"** card. Indicate the top of the photo with an arrow on back of entry.
- Photographers who wish to compete for the Texas Wildflower Award must designate "Wildflower" on the **3.5"x2"** card and on the envelope that the flower/plants category entry is also a Texas wildflower. Entry must be a verifiable Texas wildflower.
- Include proper entry fee of \$5 (\$3 youth) per photograph. Make one check or money order payable to DeWitt County Shutterbugs. **Please no cash.** Include postage-paid return mailer for mailed entries unless other arrangements have been made.
- Previous winning entries in the DeWitt County Shutterbugs Photography Contest are not admissible. DeWitt County Shutterbugs reserves the right to refuse entries deemed in poor taste. DeWitt County Shutterbugs will determine the configuration of the exhibit.
- Adult division entries require a specific category determined by the photographer. The Miscellaneous category applies **ONLY TO PHOTOS THAT FIT NO OTHER CATEGORY.** Photos classified incorrectly may be penalized with a lower score.

Pick-up and Return of Entries

All entries **must remain for the full length of the exhibition** (see schedule). Entries **must** be picked up between **9:00 a.m. and 12:00 noon on April 29, 2023**, unless mailing arrangements were included with entry. Please notify us if you will not be able to pick up your photos on April 29 to make arrangements for the handling of your entries. **ENTRIES MUST BE PICKED UP NO LATER THAN MAY 13, 2023 OR THEY WILL BE DISPOSED OF.**

Liability: The DeWitt County Shutterbugs, the Cuero Municipal Library and the City of Cuero assume no responsibility for loss or damage to photos of any kind. Plastic sleeves on photographs will not be removed by the Shutterbugs.

Checklist for Entries: *Please go over this checklist before submitting entries.*

- _____ 1. Print name, address, phone number and e-mail address on back of each entry. You may use an address label with your phone number and e-mail added.
- _____ 2. Indicate the top of the photo with an arrow on back of entry.
- _____ 3. Attach envelope to backing of each entry with the category entered written on the outside of the envelope for processing your entry.
- _____ 4. Include **3.5"x2"** business card in above envelope to be used in the display.
 - name
 - city of residence
 - category entered
 - title of photo
- _____ 5. Include Submission Form (page 4 of this document) listing all entries by category and title, and your contact information.
- _____ 6. Include a check to cover cost of entries made payable to DeWitt County Shutterbugs. Indicate on the check the name(s) of entrant(s) if different from the name on the check. **No cash, please.**
- _____ 7. Make arrangements for return shipping in the event you won't be picking up your entries on Sat., April 29, 2023.

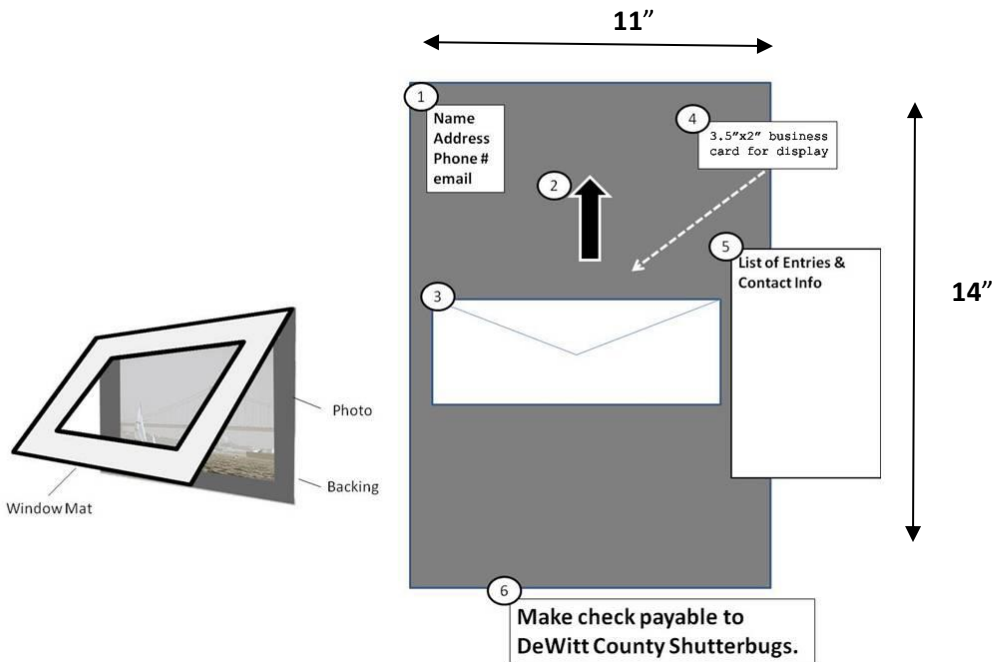

The mat and backing are sized 11 inches by 14 inches

2023 DeWitt County Shutterbugs Photography Contest Submission Form

(Please print)

Name _____ Adult _____ Youth _____ (Check one)

Address _____ City _____ State _____ Zip _____

E-mail address _____ Telephone _____

Please list the category and title of each photograph. Use one form for each person entering. Form may be copied as needed.

	CATEGORY (for adult entries)	TITLE
1.		
2.		
3.		
4.		
5.		
6.		
7.		
8.		
9.		
10.		
11.		
12.		
13.		
14.		
15.		
16.		
17.		
18.		

Total Number of Photographs Entered _____ Total Amount of Entry Fees \$ _____ Ck # _____ Postage/mailed included Y____N____ Amount of postage \$ _____

A signature is required for release for all entries so the DeWitt County Shutterbugs can place the winning photographs on their web site and other publication to advertise the contest.

Signature _____ (if under 18 parent signature is required)

<i>For club use: Processed by</i> _____
